

Serie R - Riduttori di portata in uscita

R Series - Outlet flow restrictors



CARATTERISTICHE FISICHE

Montabile su: Connessioni 8 - 10 mm
 Struttura: POM
 Compensatore: NBR / LSR



PHYSICAL SPECIFICATIONS

Can be fitted on: 8 - 10 mm connections
 Holder: POM
 Flow adjuster: NBR / LSR



CARATTERISTICHE DI LAVORO

Pressione di esercizio: 0 - 10 bar
 Direzione del fluido: Unidirezionale

WORKING SPECIFICATIONS

Working pressure: 0 - 10 bar
 Fluid direction: Unidirectional

Colore Color	Portata Flow rate L/min	Portata Flow rate GAL/min	Tolleranza * Tolerance *	Compensatore in LSR Flow adjuster in LSR	M.O.Q. (pcs)
Beige	0,08 L/min	0,02 GAL/min	± 0,05 L/min	✓	1000
Marrone / Brown	0,10 L/min	0,03 GAL/min	± 0,05 L/min		1000
Rosa / Pink	0,15 L/min	0,04 GAL/min	± 0,05 L/min	✓	1000
Rosso / Red	0,25 L/min	0,07 GAL/min	± 0,05 L/min	✓	1000
Verde / Green	0,40 L/min	0,11 GAL/min	± 0,05 L/min	✓	1000
Lime	0,50 L/min	0,13 GAL/min	± 10%	✓	1000
Grigio / Grey	0,60 L/min	0,16 GAL/min	± 10%	✓	1000
Ciano / Cyan	0,90 L/min	0,24 GAL/min	± 10%		1000
Bianco / White	1,10 L/min	0,29 GAL/min	± 10%		1000
Grigio Scuro / Dark Grey	1,40 L/min	0,37 GAL/min	± 10%		1000
Giallo / Yellow	1,70 L/min	0,45 GAL/min	± 10%		1000
Viola / Violet	2,15 L/min	0,57 GAL/min	± 10%		1000
Nero / Black	2,70 L/min	0,71 GAL/min	± 10%		1000
Blu / Blue	5,50 L/min	1,45 GAL/min	± 10%		1000
Arancione / Orange	8,40 L/min	2,22 GAL/min	± 10%		1000

* Tolleranza da valutare in base all'effettivo impiego.
 Tolerance to be evaluated based on actual use.

Serie R - Riduttori di portata in uscita

R Series - Outlet flow restrictors

Dettaglio sede Riduttore

Restrictor seat detail

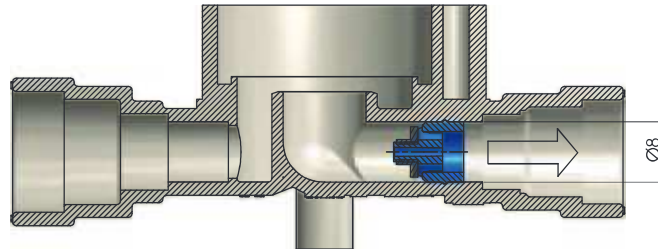

Misure in millimetri - Dimensions in millimeters

GRAFICO PORTATE / FLOW RATES CHART (Tu 60°C - Tm 25°C)



GRAFICO PORTATE / FLOW RATES CHART (Tu 60°C - Tm 25°C)



Serie R - Riduttori di portata in uscita

R Series - Outlet flow restrictors

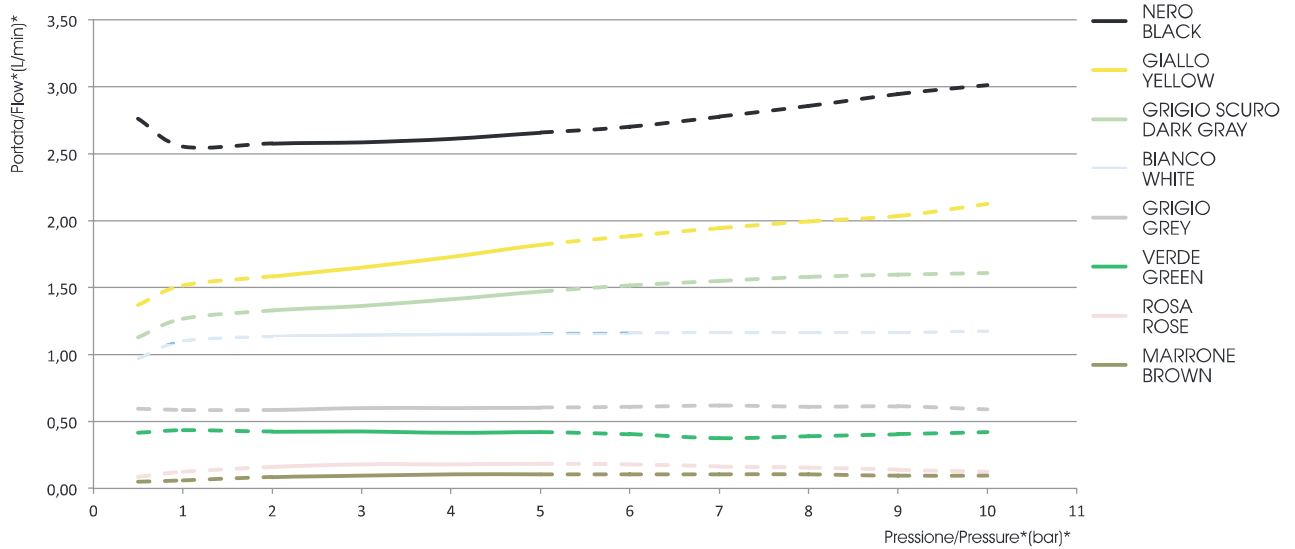
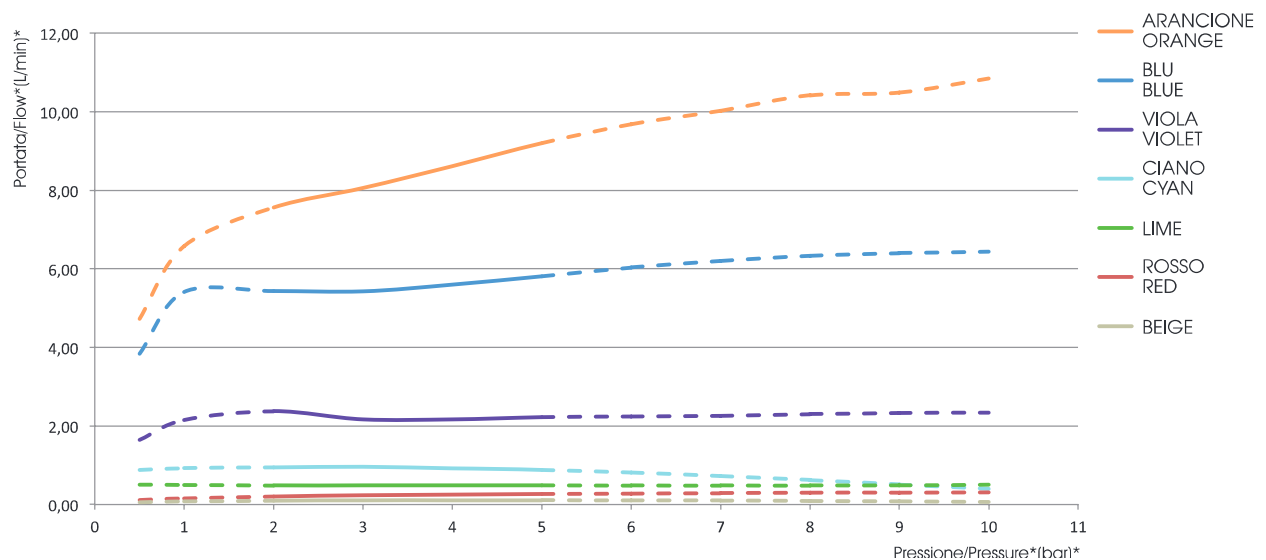
GRAFICO PORTATE / FLOW RATES CHART

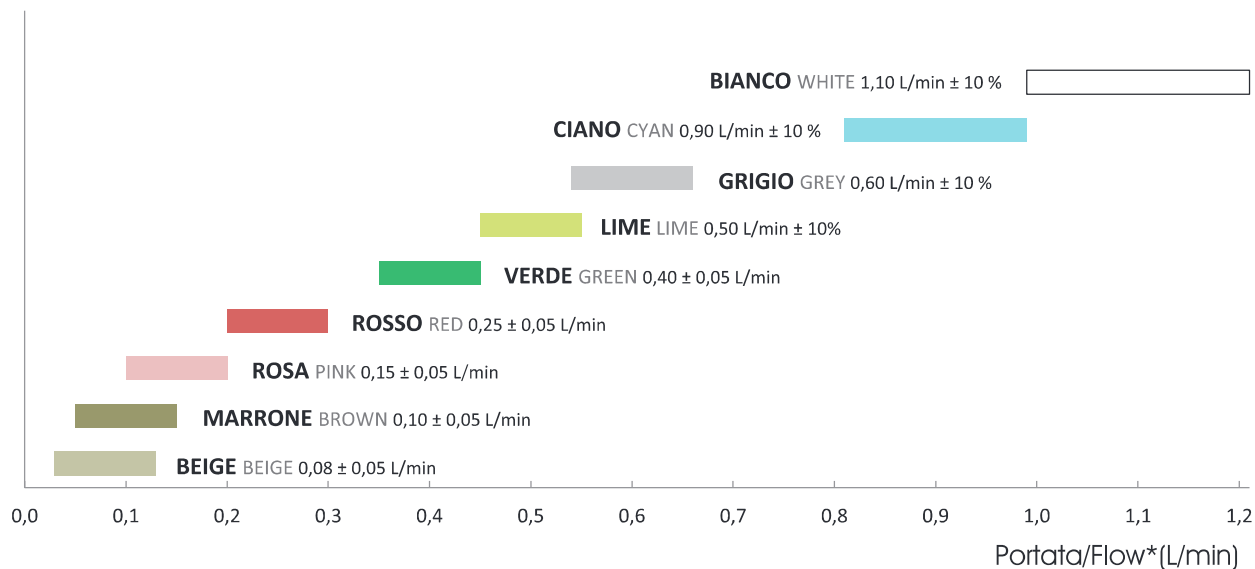

GRAFICO PORTATE / FLOW RATES CHART

